

Lao - Thai Railway Construction Project (Phase II)



Lao - Thai Railway Construction Project (Phase II)

The Employer: Railway Department (RWD)

The Engineer: TEAM Consulting Engineering and Management Co., Ltd. (TEAM) in Association with LTEC and TEAM LAO Co., Ltd.

The Contractor: Sermsanguan Construction Co., Ltd. (SERM)

THE LAYOUT PLANT OF TOTAL PHASH (3 PHASH)

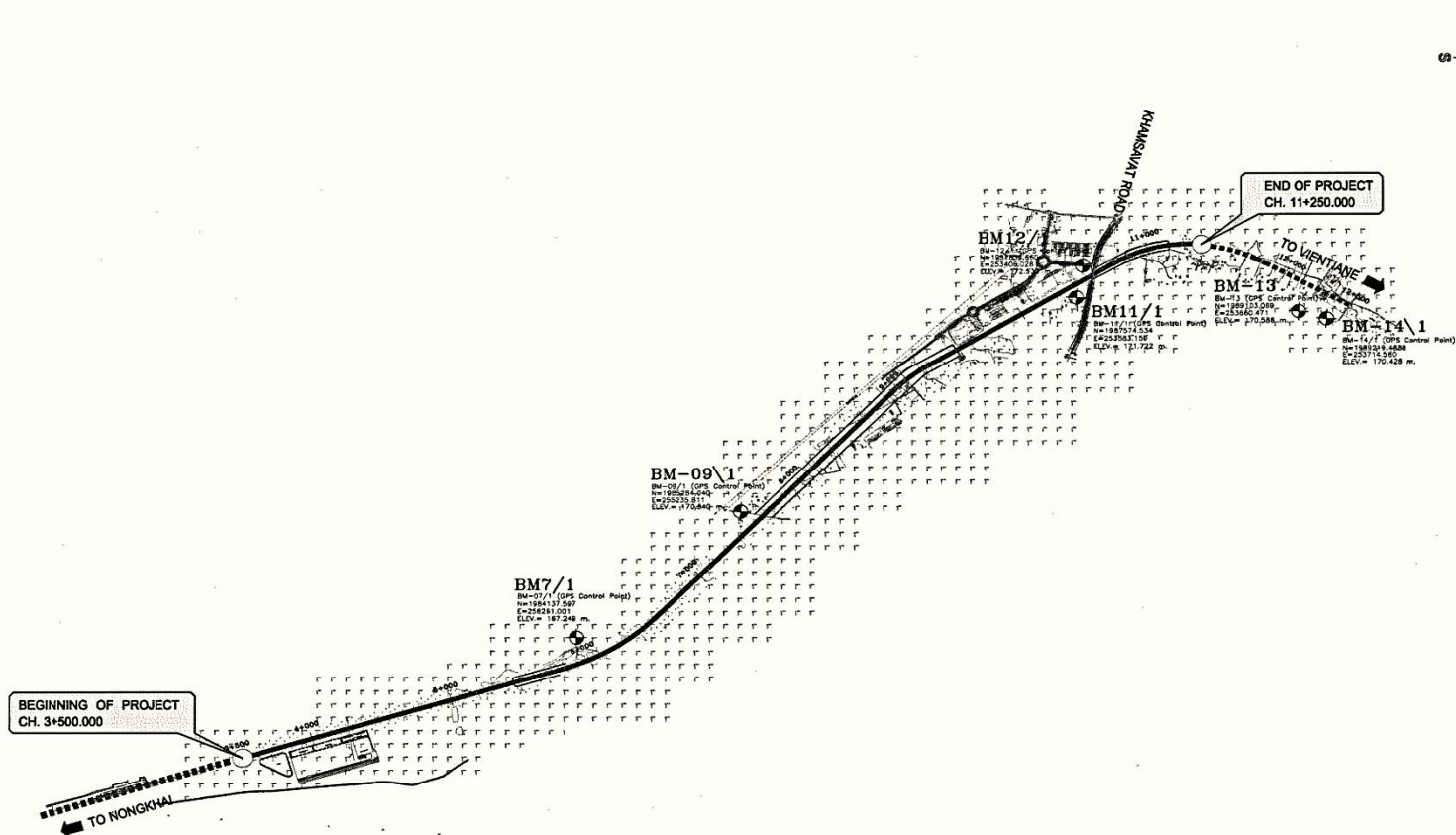

LAO PEOPLE'S DEMOCRATIC REPUBLIC
MINISTRY OF PUBLIC WORKS
AND TRANSPORT

THANALEUNG TO VIENTIANE
RAILWAY PROJECT



TEAM CONSULTING ENGINEERING
AND MANAGEMENT CO., LTD.

DRAWING BY : CHANA W.
DESIGNED BY : NIPAPORN S.
CHECKED BY : SIRI C.

PROJECT MANAGER

SUCHAI R.

TITLE
LOCATION OF CONTROL POINT
SCALE
DRAWING NO.
GR-CP-001
SHEET NO.
10

Lao- Thai Railway Construction Project (Phase II)

Construction Activities in this Phase

- **Pass 1** Railway Mainline, Track Works, Signalling and Telecommunication
- **Pass 2** Vientiane Station, RWD Main Office and Row House
- **Pass 3** VLP (Container Yard, CY), Road Works, Plate Form, Operation Office, Ware House, Gate and Weight Station, Pump House

Lao- Thai Railway Construction Project (Phase II)

Pass 1 Railway Mainline, Track Works, Signalling and
Telecommunication



TEAM Consulting Engineering and Management Co., Ltd.

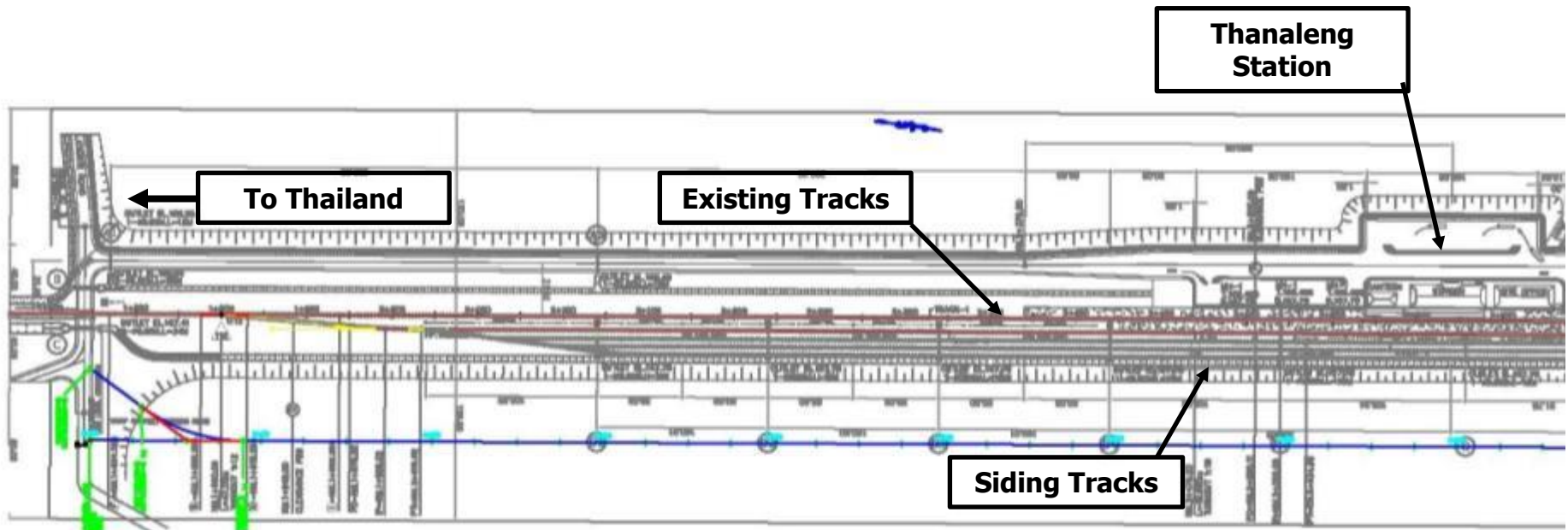

Construction of Siding at Thanaleng Station

- Construction of 3 siding Tracks, including other Related Structures
- Improvement of Signaling and Telecommunication System

Siding Track at Thanaleng Station – Pic 01

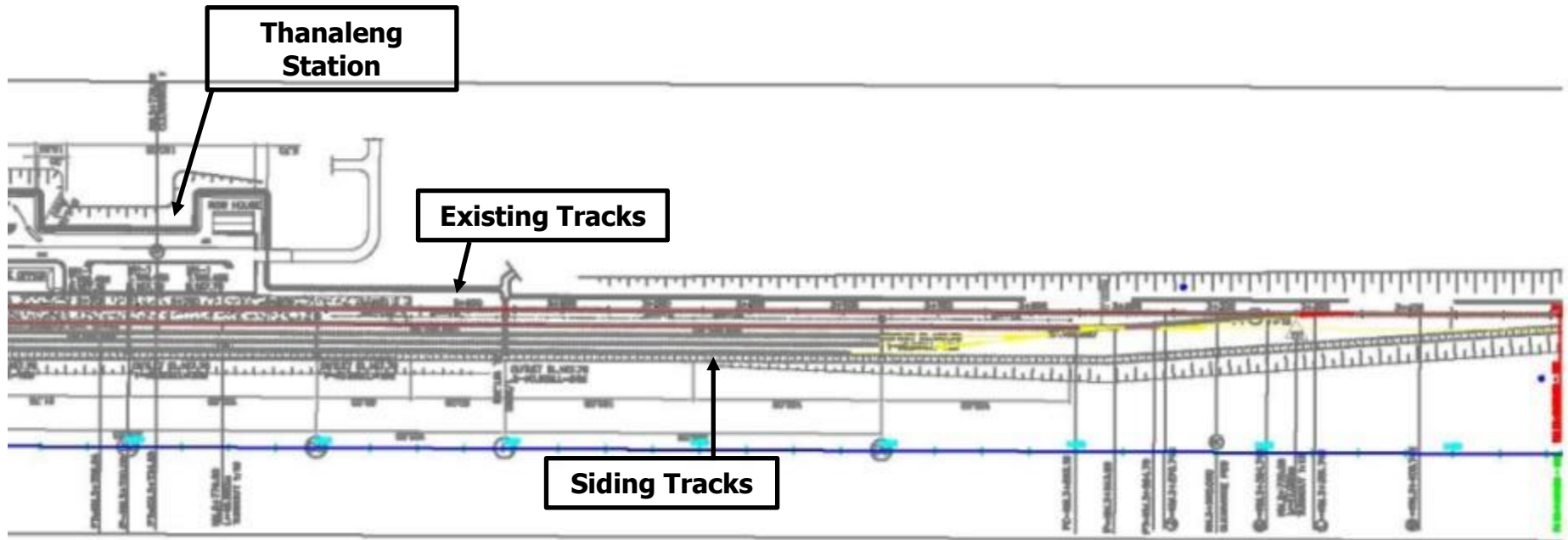

Construction of Siding at Thanaleng Station

- Construction of 3 siding Tracks, including other Related Structures
- Improvement of Signaling and Telecommunication System

Siding Track at Thanaleng Station – Pic 02

Construction Activities Picture in this Month (May 2014)

Pass 1 Railway Mainline, Track Works, Signaling and Telecommunication



Construction Activities Picture in this Month (May 2014)

Pass 1 Railway Mainline, Track Works, Signalling and Telecommunication



Construction Activities Picture in this Month (May 2014)

Pass 1 Railway Mainline, Track Works, Signalling and Telecommunication

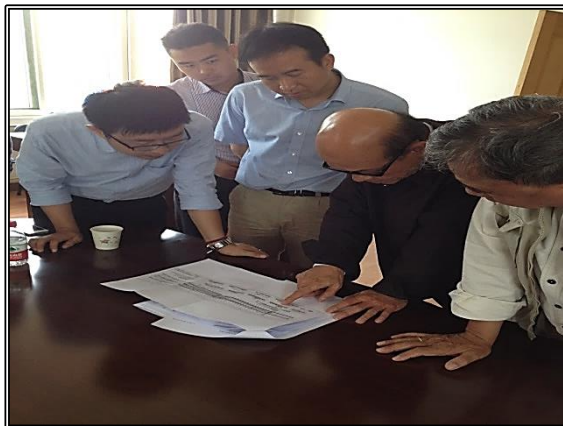
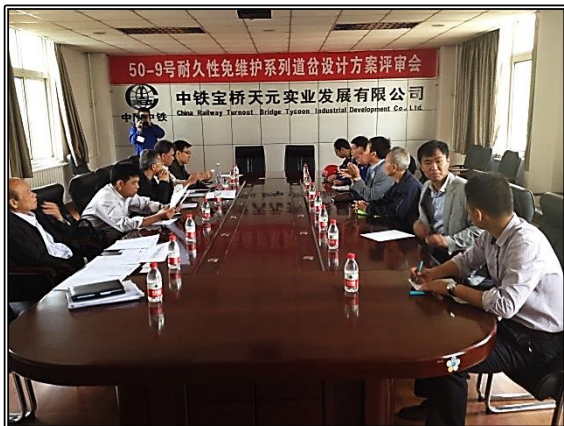

Construction Activities Picture in this Month (May 2014)

Pass 1 Railway Mainline, Track Works, Signalling and Telecommunication



CRSC

Schedule for Main Activities

NO.	Task	Start	Finish
1	Submission of Main Design Documents	18-4-2014	15-6-2014
2	Procurement	1-7-2014	31-7-2014
3	Manufacture	15-7-2014	31-8-2014
4	Logistics	1-9-2014	30-10-2014
5	Installation	1-11-2014	31-12-2014
6	Testing & Commissioning and Commercial operation	1-1-2015	30-1-2015

CRSC

Design Work

No.	Document	Status
1	System Description	Updating
2	Signalling Layout	Draft for Internal Approval
3	Route Table	On going
4	Indoor Equipment Layout	On going
5	Outdoor Cable Layout	On going



Lao - Thai Railway Construction Project (Phase II)

Pass 2 Vientiane Station, RWD Main Office and
Row House

Lao- Thai Railway Construction Project (Phase II)

Construction Activities at Vientiane Station

- Construction of Row House
- Construction of RWD's Administration Office



Width = 22 m.

Length = 60 m.

Floor = 2nd

RWD's Administration Office



Width = 15 m.

Length = 40 m.

Floor = 2nd, 16 rooms

RWD's Row House

Construction Activities Picture in this Month (May 2014)

Pass 2 Vientiane Station, RWD Main Office and Row House



Lao - Thai Railway Construction Project (Phase II)

Pass 3 VLP (Container Yard, CY), Road Works, Plate Form, Operation Office, Ware House, Gate and Weight Station, Pump House

Lao - Thai Railway Construction Project (Phase II)

Construction Activities at Container Yard (CY)

- Construction of Container Yard (CY)
- Construction of Retaining Wall and Plate Form
- Construction of Warehouses, Operator Office, Gate/W Station, Pump House
- Construction of other Related Structures, such as Drainage System, Road.

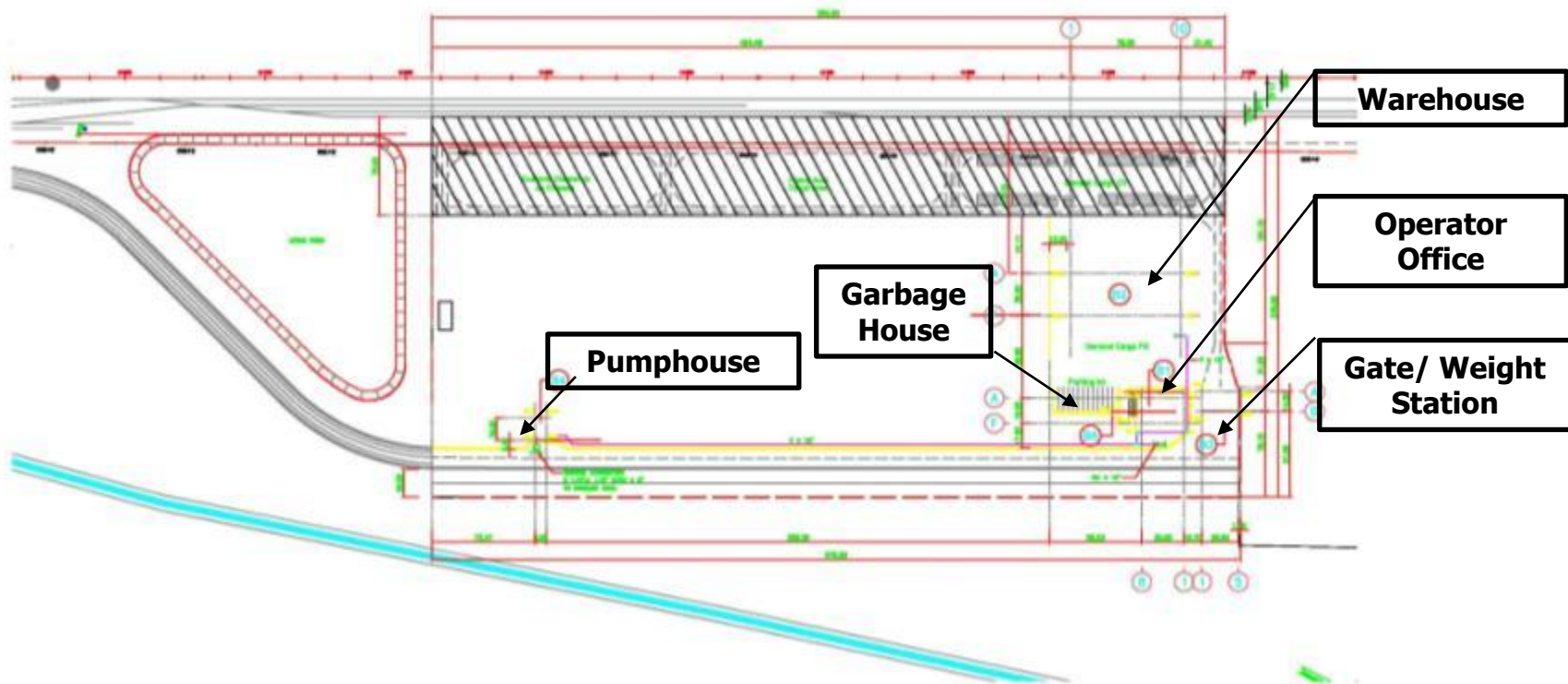

Container Yard Area

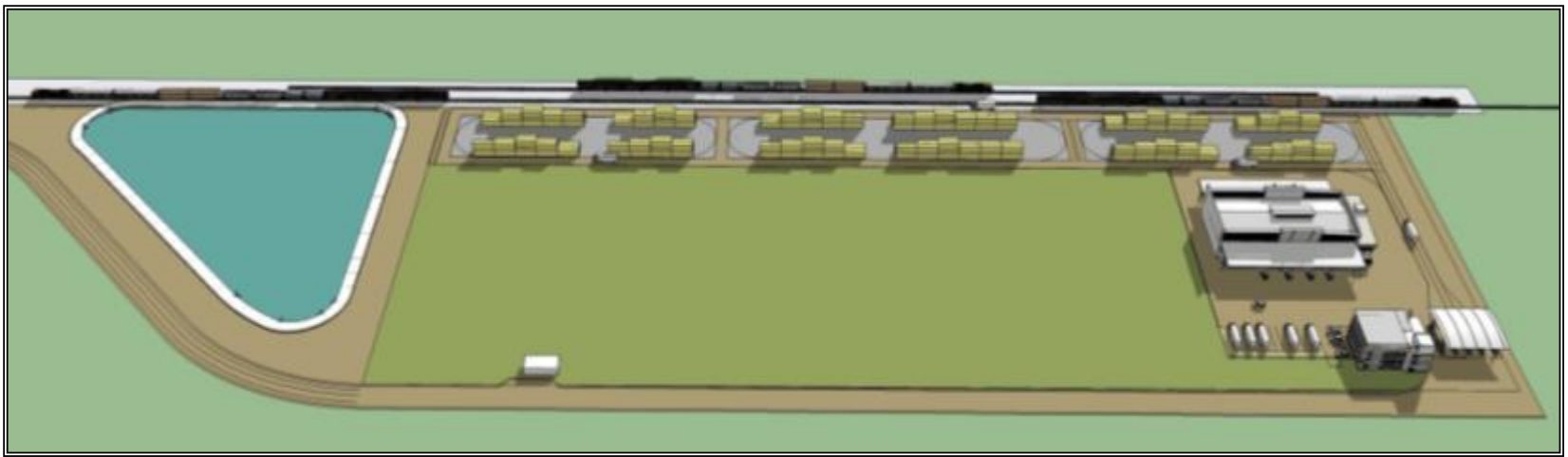

CY Layout



Width = 25 m.

Length = 30 m.

Floor = 3rd

Operation Office



Width = 30 m.

Length = 79 m.

Warehouse

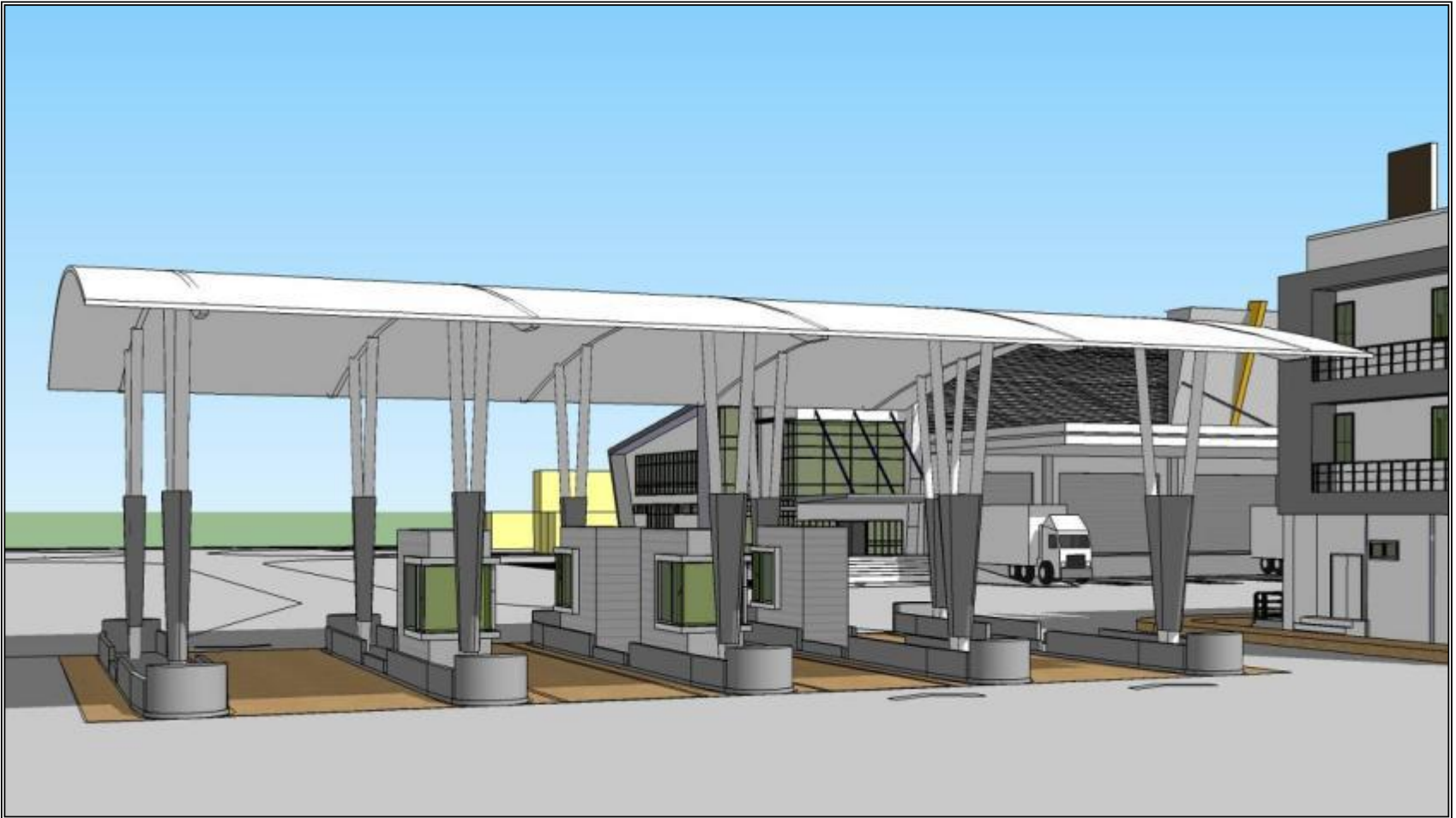

Gate and Weight Station

Construction Activities Picture in this Month (May 2014)

Pass 3 VLP (Container Yard, CY), Road Works, Plate Form, Operation Office, Ware House, Gate and Weight Station, Pump House



Construction Activities Picture in this Month (May 2014)

Pass 3 VLP (Container Yard, CY), Road Works, Plate Form, Operation Office, Ware House, Gate and Weight Station, Pump House



Lao - Thai Railway Construction Project (Phase II)

Access Road to Container Yard

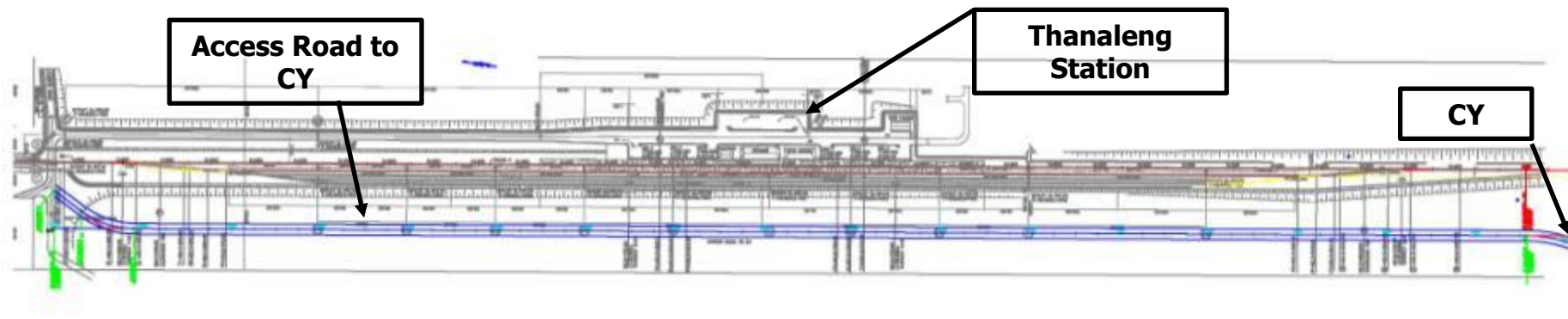

Access Road to Container Yard

- Concrete Pavement
- Carriageway 3.50 m. with shoulder 2.50 m. each both sides
- Length 2,044 meters

Construction Activities Picture in this Month (May 2014) at Access Road to CY



Work Progress up to May 2014

Plan = %

Plan October = %

Actual = 65 %

Actual October = %

Ahead = %

Work Progress up to October 2014

Thank you for your Attention